

KEY PLAN

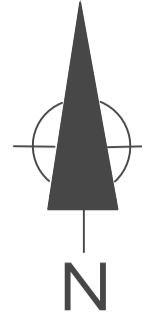

**Registered Surveyor's Certification:**

I, Anthony Valentine, being a registered/licensed surveyor and duly authorised representative of DTS Group Qld Pty Ltd hereby:

- Certify the information contained in this drawing is an accurate "as constructed" representation of the works.
- Accept responsibility for the "as constructed" information contained in this drawing.
- Acknowledge the "as constructed" information contained in the drawing may be relied on by Council and others.

Certification for Stage 1 & 2 by..... *[Signature]*  
 on 25/09/2020 for DTS Group QLD Pty Ltd  
 Reg Surveyor No.: 3115

**Consulting Engineer's Certification:**

I, ..... being a certified/registered engineer and duly authorised representative of Premise Engineers hereby:

- Certify the information in this drawing is an accurate "as constructed" representation of the works.
- Accept responsibility for the "as constructed" information contained in this drawing.
- Acknowledge the "as constructed" information contained in the drawing may be relied on by Council and others.

Certification for Stages 1 & 2 by.....  
 on ..... for KN Group Pty Ltd  
 RPEQ: .....

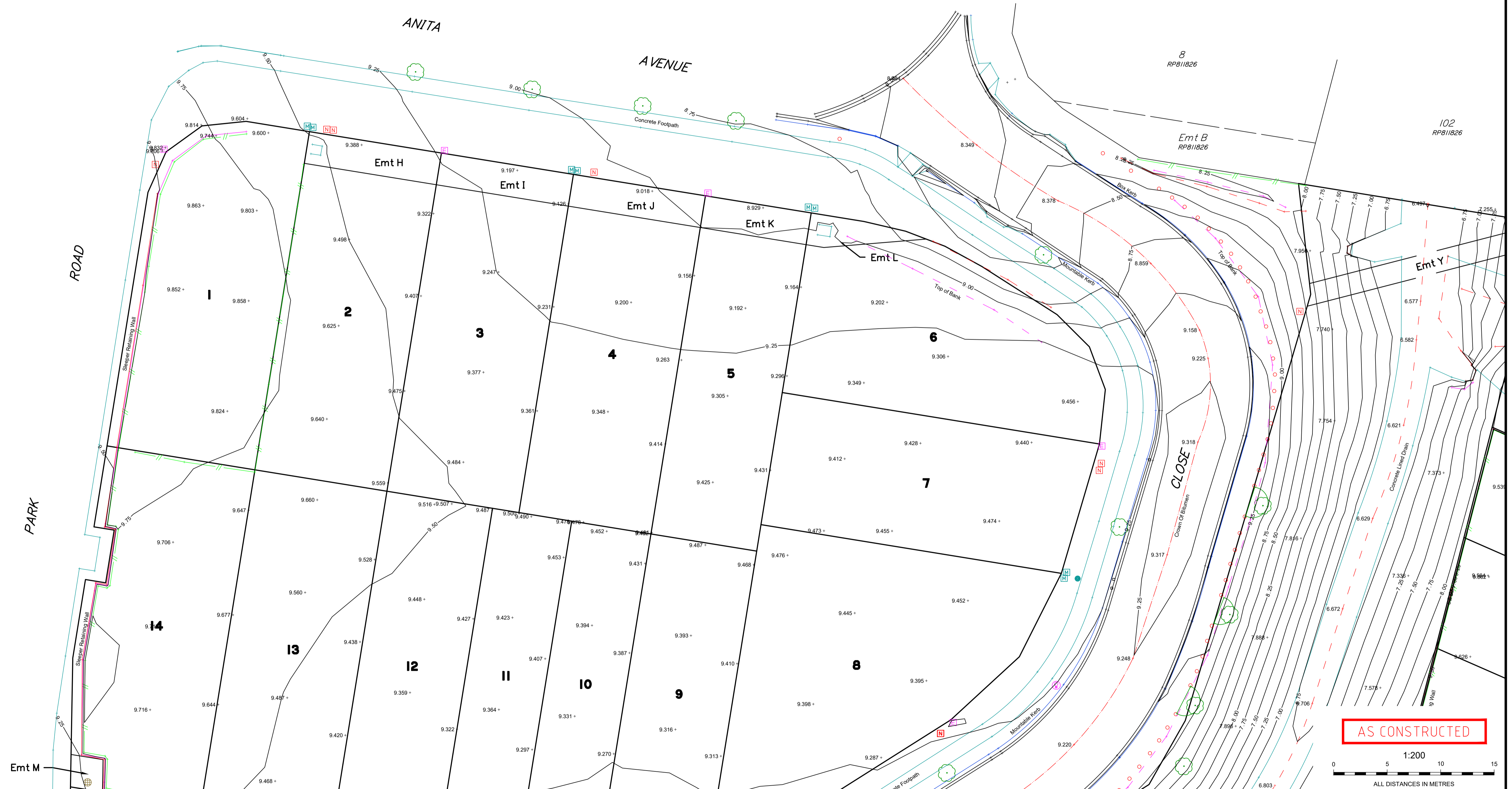

- Legend**
- Field Shot Taken Here
  - Typical Box Kerb
  - Typical T/F Kerb
  - TOG=Top of Gutter
  - RR=Roof Ridge
  - Typical Mountable Kerb
  - Electricity Box
  - Elect. Light Pole
  - Electricity Pit
  - Electricity Pole
  - Fire Hydrant
  - Gas
  - Gully Pit (Backstone)
  - Gully Pit (Centre of Grate)
  - Inspection Opening
  - Bollard
  - Sewerage MH
  - Stormwater MH
  - Telstra Pit
  - Tree
  - Valve
  - Water Meter
  - NBN Pit
  - Edge of Concrete
  - Top of Bank
  - Bottom of Bank
  - Edge Of Bit.
  - Fence
  - Crown of Road

**AS CONSTRUCTED**

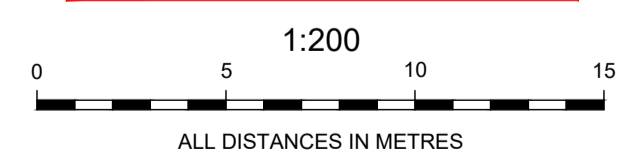

ISSUE	DATE	AS CONSTRUCTED	REVISIONS	DRAWN	CHECKED	PASSED
A	25/09/2020	AS CONSTRUCTED		AA	RC	

**dts** urban planning, surveying & development

Brisbane PO Box 3128, West End QLD 4101  
 Mackay PO Box 11711, Mackay Capentland QLD 4740  
 Ph: 07 3118 0600  
 brisbane@dtsqld.com.au    mackay@dtsqld.com.au

DRAWN	AA	25/09/2020
CHECKED	RC	25/09/2020
PASSED		
INITIALS		DATE

**Moreton Bay Regional Council**

**Real Property Description**  
 Lots 1-14 & 900 on SP315044 and  
 Lots 15-49 & 901 on SP315045  
 Locality of Deception Bay  
 Datum for Levels PM 36278 RL 9.154m AHD

**Bayside Estate Stages 1 & 2**  
 16-28 Park Road,  
 Deception Bay

**AS CONSTRUCTED CONTOURS**

SCALE	1:200 (A1)
DTS Ref:	BNE180539
DRAWING No.	A1-1437-C-1
SHEET	1 of 4 SHEETS

Sep 25, 2020 - 3:03pm



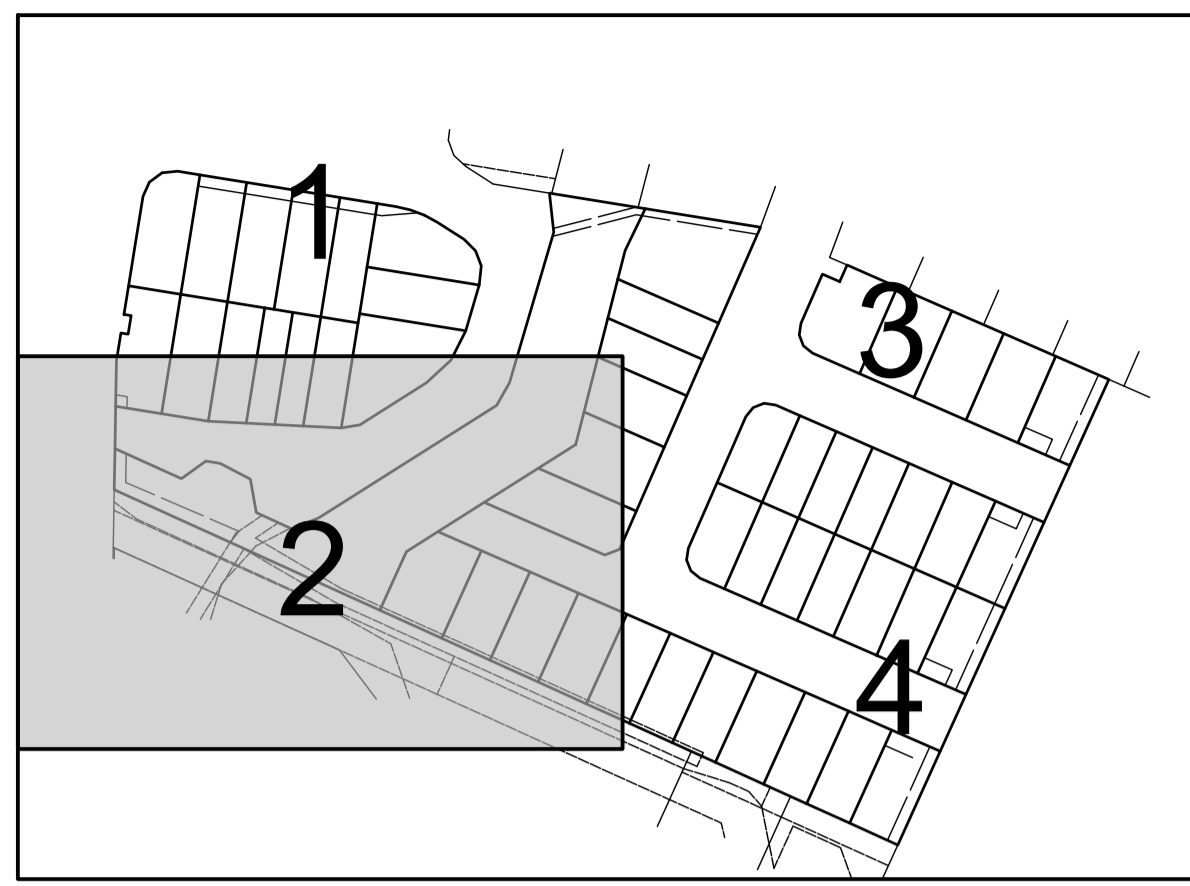

KEY PLAN

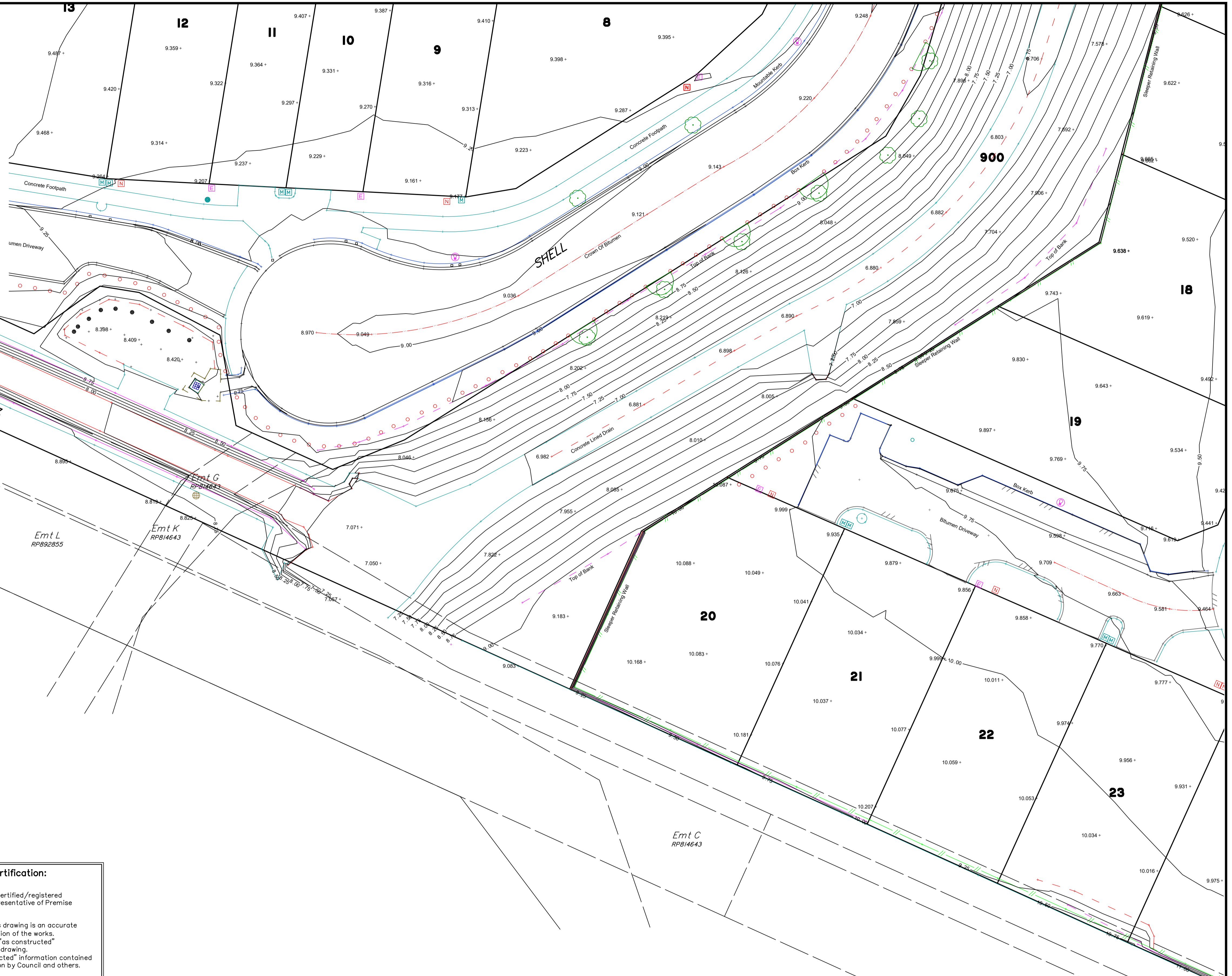
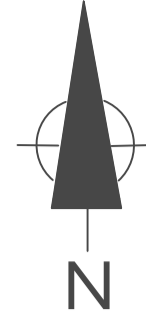

	Field Shot Taken Here
	Typical Box Kerb
	Typical Island Kerb
	TOG=Top of Gutter
	RR=Roof Ridge
	Typical Mountable Kerb
	Electricity Box
	Elect. Light Pole
	Electricity Pit
	Electricity Pole
	Fire Hydrant
	Gas
	Gully Pit (Backstone)
	Gully Pit (Centre of Grate)
	Inspection Opening
	Bollard
	Sewerage MH
	Stormwater MH
	Telstra Pit
	Tree
	Valve
	Water Meter
	NBN Pit
	Edge of Concrete
	Top of Bank
	Bottom of Bank
	Edge Of Bl.
	Fence
	Crown of Road

**Registered Surveyor's Certification:**  
 I, Anthony Valentine, being a registered/licensed surveyor and duly authorised representative of DTS Group QLD Pty Ltd hereby:  
 - Certify the information contained in this drawing is an accurate "as constructed" representation of the works.  
 - Accept responsibility for the "as constructed" information contained in this drawing.  
 - Acknowledge the "as constructed" information contained in the drawing may be relied on by Council and others.  
 Certification for Stage 1 & 2 by..... on 25/09/2020 for DTS Group QLD Pty Ltd  
 Reg Surveyor No.: 3115

**Consulting Engineer's Certification:**  
 I, ..... being a certified/registered engineer and duly authorised representative of Premise Engineers hereby:  
 - Certify the information in this drawing is an accurate "as constructed" representation of the works.  
 - Accept responsibility for the "as constructed" information contained in this drawing.  
 - Acknowledge the "as constructed" information contained in the drawing may be relied on by Council and others.  
 Certification for Stages 1 & 2 by..... on ..... for KN Group Pty Ltd  
 RPEQ: .....

AS CONSTRUCTED



ISSUE	DATE	AS CONSTRUCTED	REVISIONS	DRAWN	CHECKED	PASSED
A	25/09/2020	AS CONSTRUCTED		AA	RC	

**dts** urban planning, surveying & development  
 Brisbane PO Box 3128, West End QLD 4101  
 Ph: 07 3118 0600  
 brisbane@dtsqld.com.au  
 Mackay PO Box 11711, Mackay Caneland QLD 4740  
 Ph: 1300 278 783  
 mackay@dtsqld.com.au

DRAWN	CHECKED	PASSED	INITIALS	DATE
AA	RC			25/09/2020



**Moreton Bay Regional Council**  
**Real Property Description**  
 Lots 1-14 & 900 on SP315044 and  
 Lots 15-49 & 901 on SP315045  
 Locality of Deception Bay  
 Datum for Levels PM 36278 RL 9.154m AHD

**Bayside Estate Stages 1 & 2**  
 16-28 Park Road,  
 Deception Bay  
**AS CONSTRUCTED CONTOURS**

SCALE 1:200 (A1)	DTS Ref: BNE180539
DRAWING No. A1-1437-C-2	A
SHEET 2 of 4 SHEETS	

Sep 25, 2020 - 3:03pm



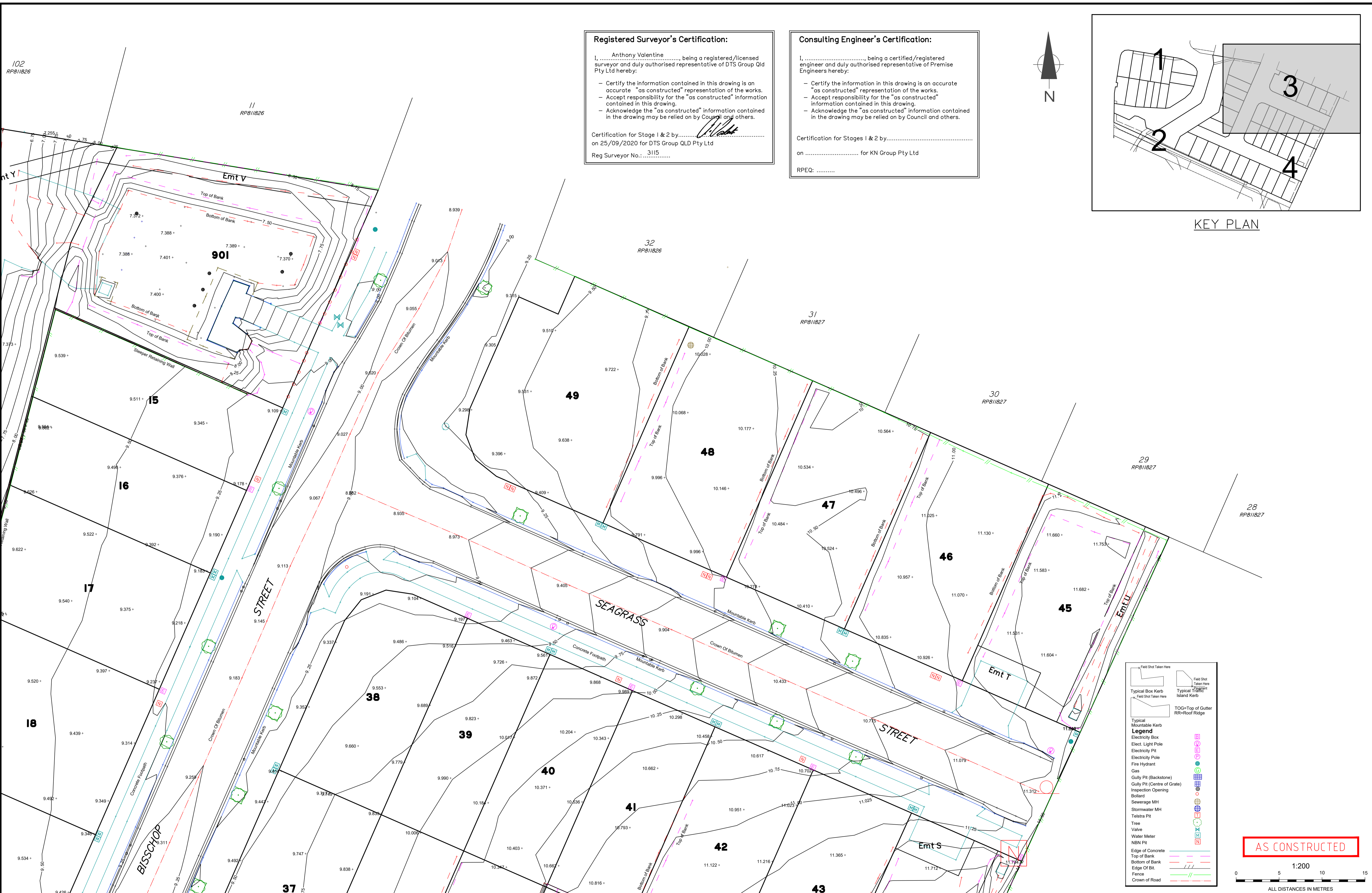

**Registered Surveyor's Certification:**  
 I, Anthony Valentine, being a registered/licensed surveyor and duly authorised representative of DTS Group Old Pty Ltd hereby:  
 - Certify the information contained in this drawing is an accurate "as constructed" representation of the works.  
 - Accept responsibility for the "as constructed" information contained in this drawing.  
 - Acknowledge the "as constructed" information contained in the drawing may be relied on by Council and others.  
 Certification for Stage 1 & 2 by.....  
 on 25/09/2020 for DTS Group QLD Pty Ltd  
 3115  
 Reg Surveyor No.:.....

**Consulting Engineer's Certification:**  
 I, ..... being a certified/registered engineer and duly authorised representative of Premise Engineers hereby:  
 - Certify the information in this drawing is an accurate "as constructed" representation of the works;  
 - Accept responsibility for the "as constructed" information contained in this drawing.  
 - Acknowledge the "as constructed" information contained in the drawing may be relied on by Council and others.  
 Certification for Stages 1 & 2 by.....  
 on ..... for KN Group Pty Ltd  
 RPEQ: .....

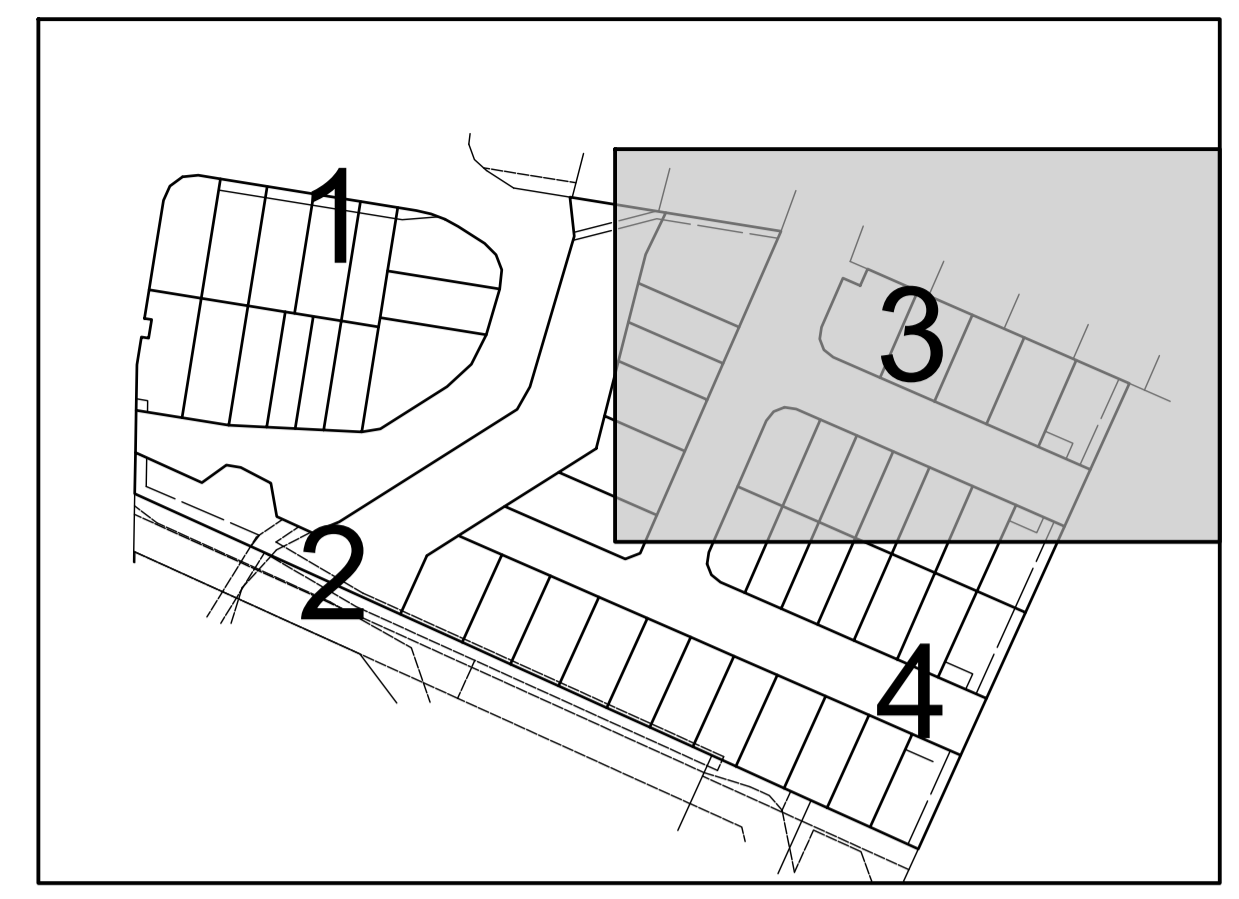
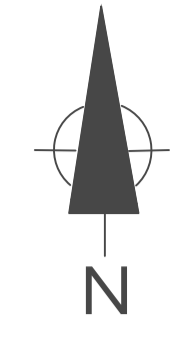

KEY PLAN

Field Shot Taken Here

Typical Box Kerb

Typical Mountable Kerb

Legend

- Electricity Box
- Elect. Light Pole
- Electricity Pit
- Electricity Pole
- Fire Hydrant
- Gas
- Gully Pit (Backstone)
- Gully Pit (Centre of Grate)
- Inspection Opening
- Bollard
- Sewerage MH
- Stormwater MH
- Telstra Pit
- Tree
- Valve
- Water Meter
- NBN Pit
- Edge of Concrete
- Top of Bank
- Bottom of Bank
- Edge Of Bit
- Fence
- Crown of Road

TOG=Top of Gutter  
RR=Roof Ridge

AS CONSTRUCTED

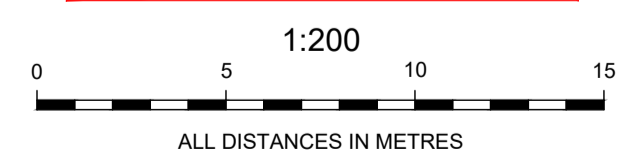

ISSUE	DATE	AS CONSTRUCTED	REVISIONS	DRAWN	CHECKED	PASSED
A	25/09/2020	AS CONSTRUCTED		AA	RC	

**dts** urban planning, surveying & development

Brisbane Mackay  
 PO Box 3128, West End QLD 4101 PO Box 11711, Mackay Queensland QLD 4740  
 Ph: 07 3118 0600 Ph: 1300 278 783  
 brisbane@dtsqld.com.au mackay@dtsqld.com.au

DRAWN	AA	25/09/2020
CHECKED	RC	25/09/2020
PASSED		
INITIALS		DATE

**Moreton Bay Regional Council**

**Real Property Description**  
 Lots 1-14 & 900 on SP315044 and  
 Lots 15-49 & 901 on SP315045  
 Locality of Deception Bay  
 Datum for Levels PM 36278 RL 9.154m AHD

**Bayside Estate Stages 1 & 2**  
 16-28 Park Road,  
 Deception Bay  
**AS CONSTRUCTED CONTOURS**

SCALE	1:200 (A1)
DTS Ref:	BNE180539
DRAWING No.	A1-1437-C-3
SHEET	3 of 4 SHEETS



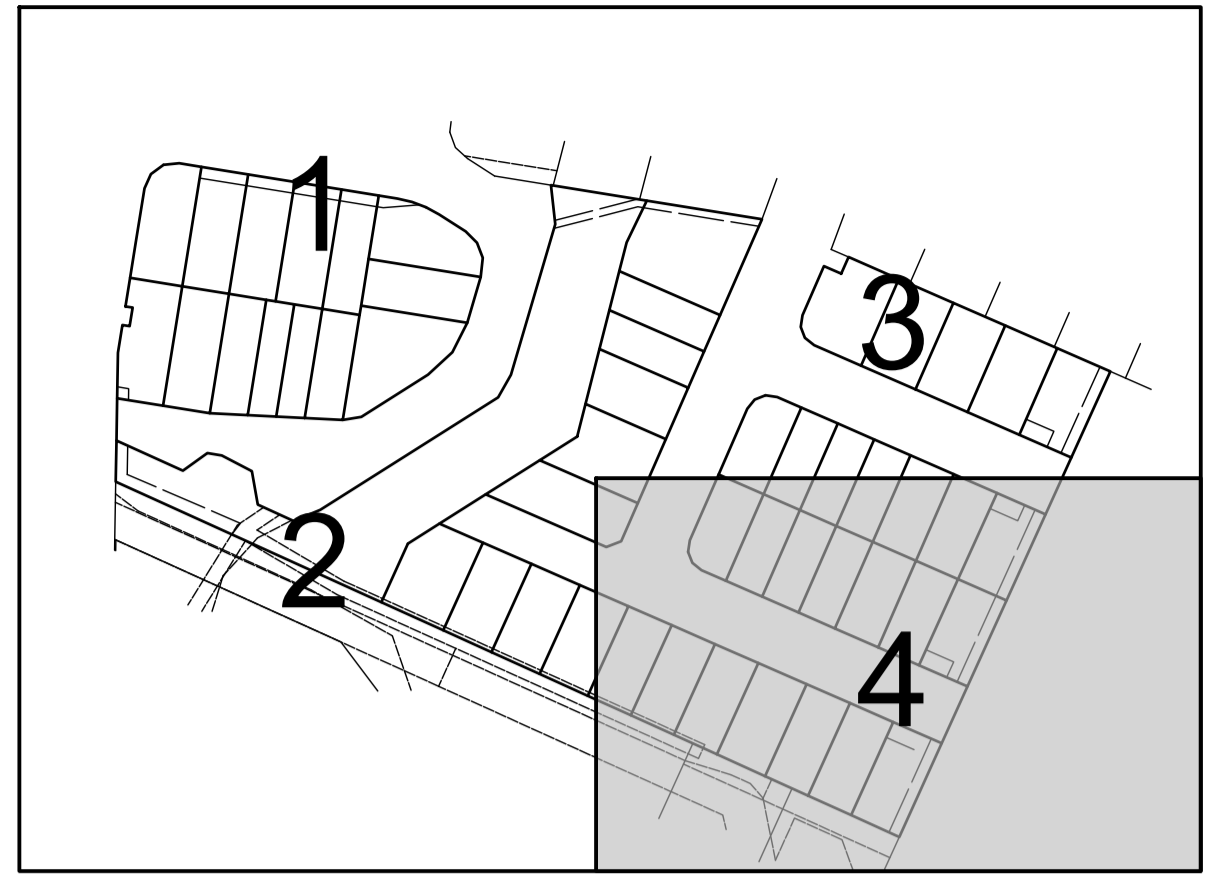

KEY PLAN

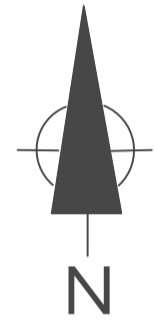

Field Shot Taken Here	Field Shot Taken Here
Typical Box Kerb	Typical Traffic Island Kerb
Typical Mountable Kerb	TOG-Top of Gutter
Typical Electric Box	RR-Roof Ridge
Elect. Light Pole	
Electricity Pit	
Electricity Pole	
Fire Hydrant	
Gas	
Gully Pit (Backstone)	
Gully Pit (Centre of Grate)	
Inspection Opening	
Bollard	
Sewerage MH	
Stormwater MH	
Teitra Pit	
Tire	
Valve	
Water Meter	
NBN Pit	
Edge of Concrete	
Top of Bank	
Bottom of Bank	
Edge of St.	
Fence	
Crown of Road	

**Registered Surveyor's Certification:**

I, Anthony Valentine, being a registered/licensed surveyor and duly authorised representative of DTS Group Qld Pty Ltd hereby:

- Certify the information contained in this drawing is an accurate "as constructed" representation of the works.
- Accept responsibility for the "as constructed" information contained in this drawing.
- Acknowledge the "as constructed" information contained in the drawing may be relied on by Council and others.

Certification for Stage 1 & 2 by..... on 25/09/2020 for DTS Group QLD Pty Ltd  
Reg Surveyor No.: 3115

**Consulting Engineer's Certification:**

I, ..... being a certified/registered engineer and duly authorised representative of Premise Engineers hereby:

- Certify the information in this drawing is an accurate "as constructed" representation of the works.
- Accept responsibility for the "as constructed" information contained in this drawing.
- Acknowledge the "as constructed" information contained in the drawing may be relied on by Council and others.

Certification for Stages 1 & 2 by..... on ..... for KN Group Pty Ltd  
RPEQ: .....

AS CONSTRUCTED

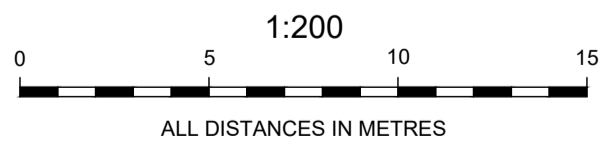

ISSUE	DATE	AS CONSTRUCTED	REVISIONS	DRAWN	CHECKED	PASSED
A	25/09/2020	AS CONSTRUCTED		AA	RC	

**dts** urban planning, surveying & development

Brisbane PO Box 3128, West End QLD 4101  
Ph: 07 3118 0600  
brisbane@dtsqld.com.au

Mackay PO Box 11711, Mackay Central QLD 4740  
Ph: 1300 278 783  
mackay@dtsqld.com.au

DRAWN	AA	25/09/2020
CHECKED	RC	25/09/2020
PASSED		
INITIALS		DATE

**Moreton Bay Regional Council**

**Real Property Description**  
Lots 1-14 & 900 on SP315044 and  
Lots 15-49 & 901 on SP315045  
Locality of Deception Bay  
Datum for Levels PM 36278 RL 9.154m AHD

**Bayside Estate**  
Stages 1 & 2  
16-28 Park Road,  
Deception Bay

AS CONSTRUCTED CONTOURS

SCALE	1:200 (A1)
DTS Ref:	BNE180539
DRAWING No.	A1-1437-C-4
SHEET	4 of 4 SHEETS