

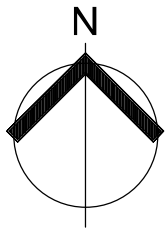

# PINNACLE

## HOLMVIEW



Retaining Wall in Lot 24  
 Max Height : 1.4m  
 Min Height : 1.07m  
 Average Height : 1.24m

WURAGA ROAD

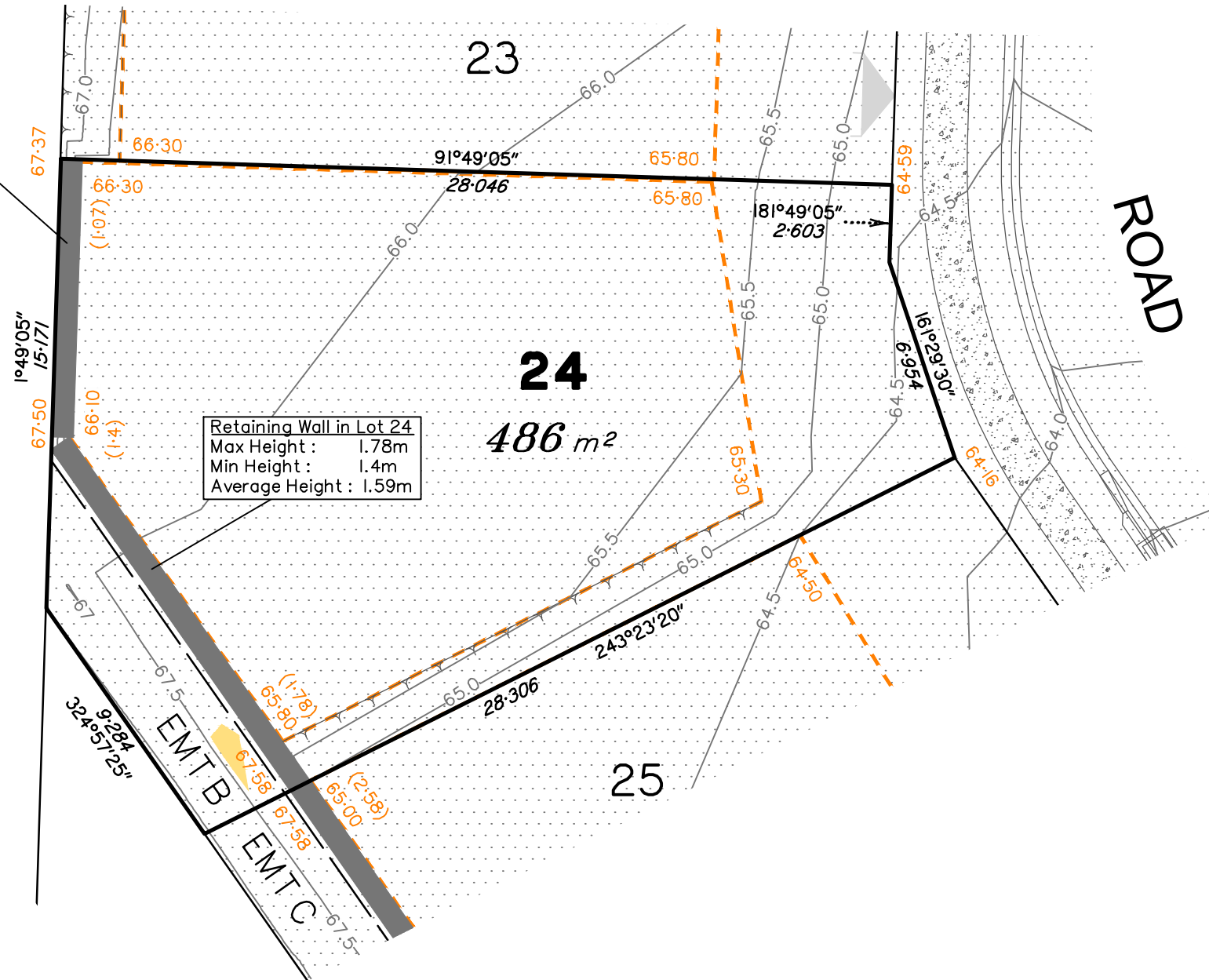

Retaining Wall in Lot 24  
 Max Height : 1.78m  
 Min Height : 1.4m  
 Average Height : 1.59m

ROAD

90  
 SP260522



**GALLERY**  
 DEVELOPMENTS

SCALE @ A3 1:200 - LENGTHS ARE IN METRES

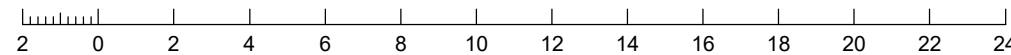

### LEGEND

- Area of Cut
- Area of Fill
- Design Contours (0.50m Interval)
- Depth of Fill Contours (0.50m Interval)
- Proposed Retaining Wall (Height shown in brackets on lower side)
- Proposed Earthworks Pad
- Proposed Earthworks Pad Design Level
- Top of Batter
- Toe of Batter
- Indicative Driveway Location

(Not all items in this legend may be relevant to the lot shown hereon)

### NOTES

This plan has been prepared from preliminary survey plan (SP313780) and engineering data provided on the 03/04/2020 by Burchills Engineering Solutions.

Development approval was granted for this subdivision by the Logan City Council on 12/09/2019. (Application number: COM/31/2019) For updates to the development approval visit: [pdonline.logan.qld.gov.au](http://pdonline.logan.qld.gov.au).

Development approval for operational works for this subdivision was granted on 10/03/2020 by Logan City Council (Ref: OW/162/2019).

The purchaser should refer to the applicable development approvals for building and/or other requirements that may be applicable to the lot.

Lot 24 contains Easement B on SP313780 for services benefiting Logan City Council.

Parts of Lot 24 are subject to areas of fill less than 0.5m in depth.

No.	by	Date	Description
A	TBG	27/09/19	Original Issue
B	TBG	24/04/20	Updated as per new civil data & minor alt



Saunders Havill Group Pty Ltd ABN 24 144 972 949  
 Brisbane • Springfield • Rockhampton  
 head office 9 Thompson St Bowen Hills Q 4006  
 phone 1300 123 SHG web [www.saundershavill.com](http://www.saundershavill.com)

■ surveying ■ town planning ■ urban design ■ environmental management ■ landscape architecture

This Disclosure Plan is prepared for the sole purpose of satisfying the Disclosure requirements of the Land Sales Act and SHOULD NOT be used for any other purpose, particularly as-constructed purposes. This information is compiled from design plans only, unless otherwise stated, and therefore is subject to final survey and construction of operational works.

### Disclosure Plan for Proposed Lot 24 on SP313780

Described as part of Lot 91 on SP260522  
 Existing Title Reference: 50968066

Locality of Holmview (Logan City Council)

Level Datum: AHD der.  
 Origin of Levels: PM 203698  
 RL of Origin: 50.908  
 Contour Interval: 0.50m

Scale @A3 1:200  
 Plan No. 9510 S 03 DP B\_24