

PINNACLE

HOLMVIEW

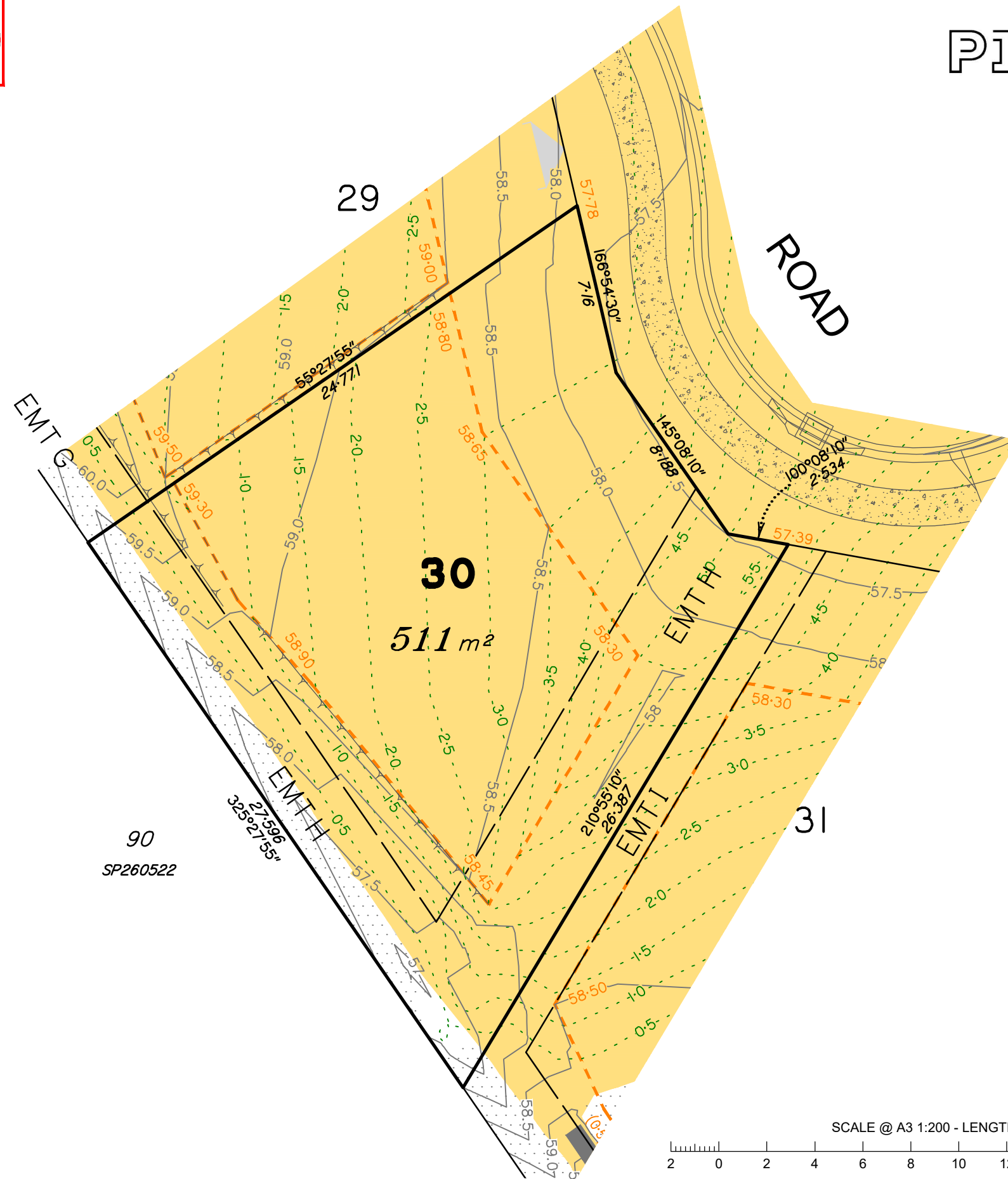

LEGEND

- Area of Cut
- Area of Fill
- Design Contours (0.50m Interval)
- Depth of Fill Contours (0.50m Interval)
- Proposed Retaining Wall (Height shown in brackets on lower side)
- Proposed Earthworks Pad
- Proposed Earthworks Pad Design Level
- Top of Batter
- Toe of Batter
- Indicative Driveway Location

(Not all items in this legend may be relevant to the lot shown hereon)

NOTES

This plan has been prepared from preliminary survey plan (SP313780) and engineering data provided on the 03/04/2020 by Burchills Engineering Solutions.

Development approval was granted for this subdivision by the Logan City Council on 12/09/2019. (Application number: COM/31/2019)
For updates to the development approval visit: pdonline.logan.qld.gov.au.

Development approval for operational works for this subdivision was granted on 10/03/2020 by Logan City Council (Ref: OW/162/2019).

All fill shall be placed and compacted in a controlled manner under Level 1 supervision and certification in accordance with AS3798-2007.

The purchaser should refer to the applicable development approvals for building and/or other requirements that may be applicable to the lot.

Lot 30 contains Easement H on SP313780 for services benefiting Logan City Council.

SCALE @ A3 1:200 - LENGTHS ARE IN METRES

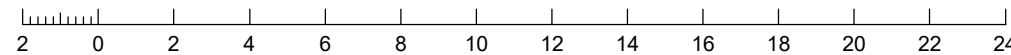

No.	by	Date	Description
A	TBG	27/09/19	Original Issue
B	TBG	24/04/20	Updated as per new civil data & minor alt



■ surveying ■ town planning ■ urban design ■ environmental management ■ landscape architecture

Saunders Havill Group Pty Ltd ABN 24 144 972 949
Brisbane ■ Springfield ■ Rockhampton
head office 9 Thompson St Bowen Hills Q 4006
phone 1300 123 SHG web www.saundershavill.com

This Disclosure Plan is prepared for the sole purpose of satisfying the Disclosure requirements of the Land Sales Act and SHOULD NOT be used for any other purpose, particularly as-constructed purposes. This information is compiled from design plans only, unless otherwise stated, and therefore is subject to final survey and construction of operational works.

Disclosure Plan for Proposed Lot 30 on SP313780

Described as part of Lot 91 on SP260522
Existing Title Reference: 50968066

Locality of Holmview (Logan City Council)

Level Datum: AHD der.
Origin of Levels: PM 203698
RL of Origin: 50.908
Contour Interval: 0.50m

Scale @A3 1: 200
Plan No. 9510 S 03 DP B_30