

Compaction of any fill material placed on this Proposed site shall be completed under inspection and Lot 4 testing services in accordance with AS3798-2007.

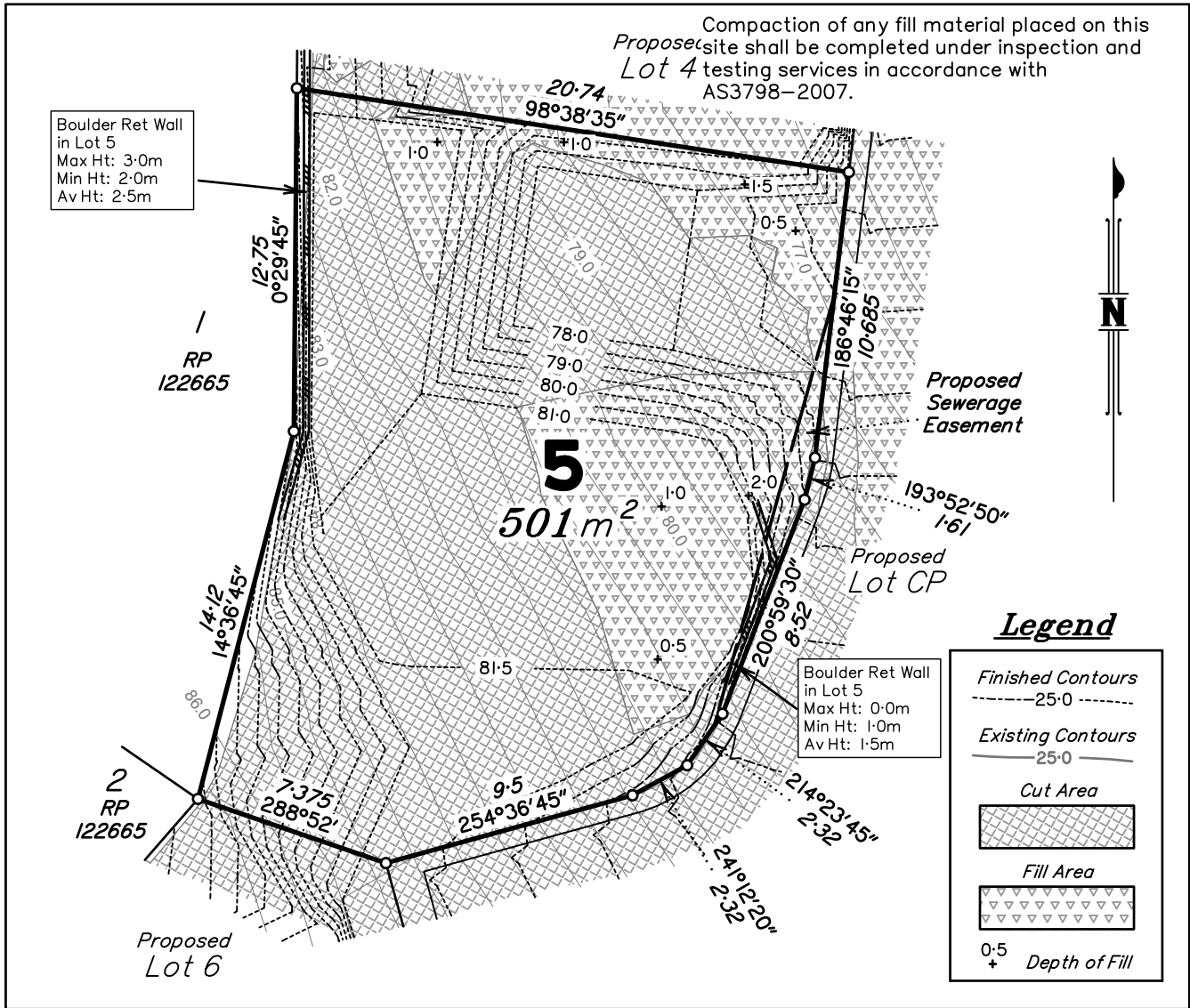

Certification of Proposed Allotment 5 Details

This plan illustrates Proposed Lot 5 as approved by The Planning Environment Court order D98 of 2009 dated 15/10/2010 and Sunshine Coast Regional Council Generally in Accordance Request file: REC08/0039.02, dated 4/08/2014, for Reconfiguration of a Lot, and in accordance with Operational Works Permit No. OPWI4/0296.02 dated 13/04/2018 and MOTUS Consulting Engineers Drawings No. MC312 Drawing No. C001 dated 24/08/17 and subsequent sheets and amendments as approved by Sunshine Coast Regional Council.

Notes

- Contours shown are Existing & Final Design levels derived from Detail Survey & Engineers Drawings and are shown at 0.5m intervals. Contours are not suitable for building design purposes.
- All areas and dimensions are subject to council sealing of the Survey Plan and registration in the Department of Natural Resources and Mines.
- This Plan is to be used as an attachment under the Land Sales Act to sell Freehold Land off the Plan.

Scale 1:250 – Lengths are in Metres.

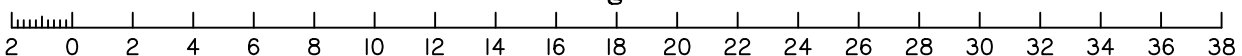

MURRAY & ASSOCIATES
SURVEYORS & TOWN PLANNERS
ACN 075 543 154
Murray Building, 15-17 Currie St. Nambour Ph. (07)5441 2188 P.O. Box 246
Branch Offices at Caboolture Chinchilla Roma Gympie & Emerald
CADASTRAL SURVEYOR

Disclosure Plan for Proposed Lot 5
(currently part of Lot 3 on RP901068)

LOCAL AUTHORITY: SUNSHINE COAST R.C. LOCALITY: Nambour

CLIENT:	BRUCE GRADY		
DATE:	20/10/2020	SCALE:	1:250
COMP:	43246_(Disclosure)	Level Datum:	PM102651
FILE:	Grady.dwg		RL 52.562m
MAP REF:	9444-11233		AHD(D)
CONTOUR INT:	0.5 m	ORIG POR:	21
DRAWN:	DJ/LF	JOB No:	43246/5b
CHECKED:	AJC		