

# VUE

## NAMBOUR

23 BAILEY STREET, NAMBOUR, QUEENSLAND, 4560

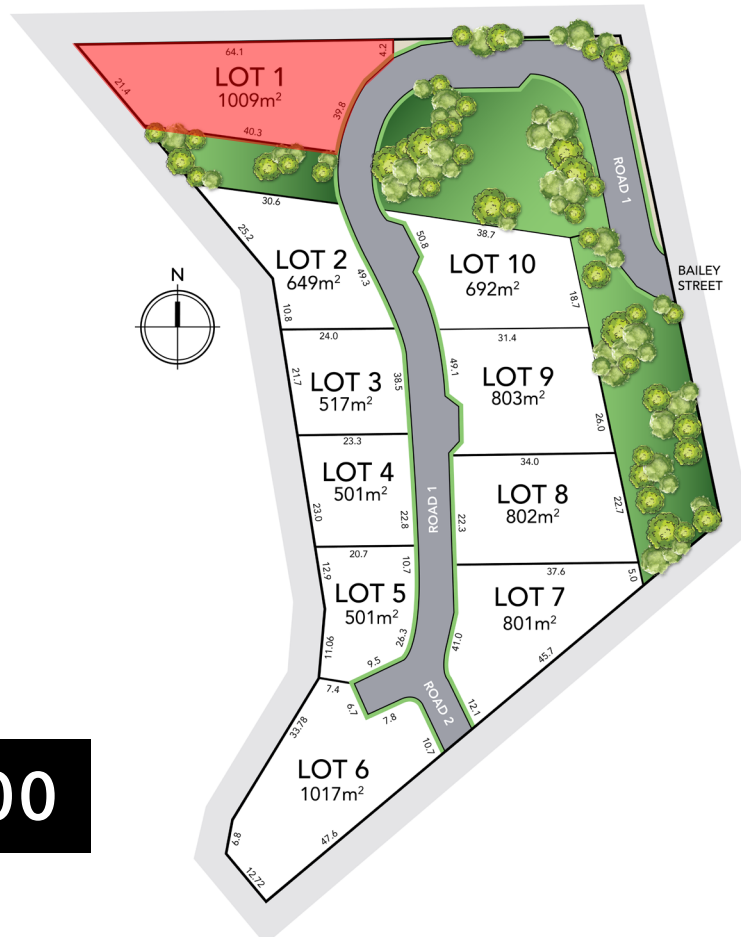
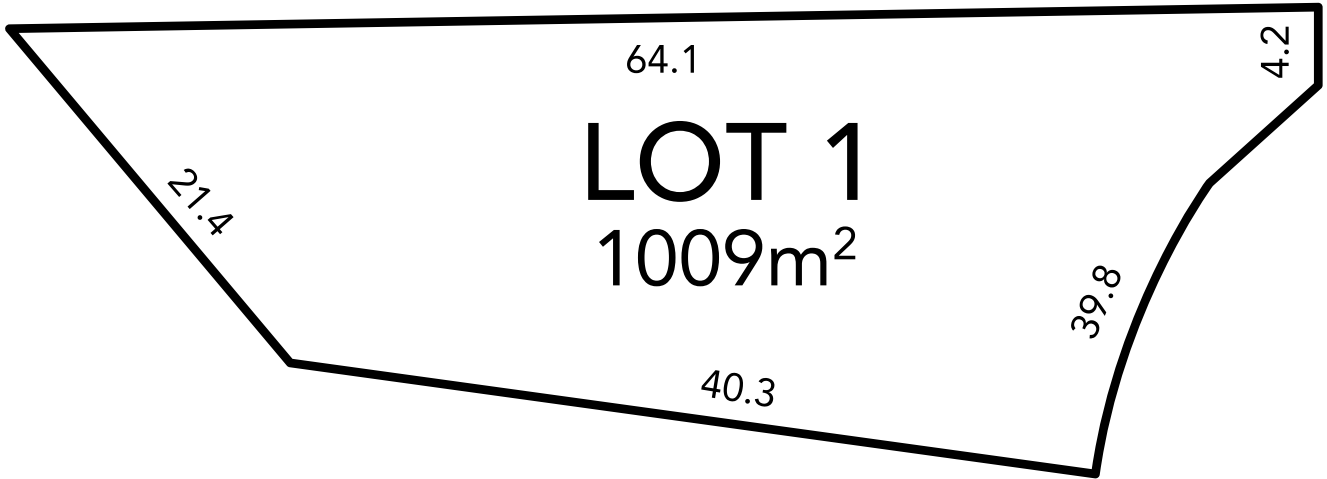

**\$300,000**

Prices are correct as of 23 September 2020 & do not include stamp duty, registration fees, or any other incidental fees associated with the acquisition of land. Scheduled completion timeframe is indicative only and subject to change without notice.

# VUE

## NAMBOUR

23 BAILEY STREET, NAMBOUR, QUEENSLAND, 4560

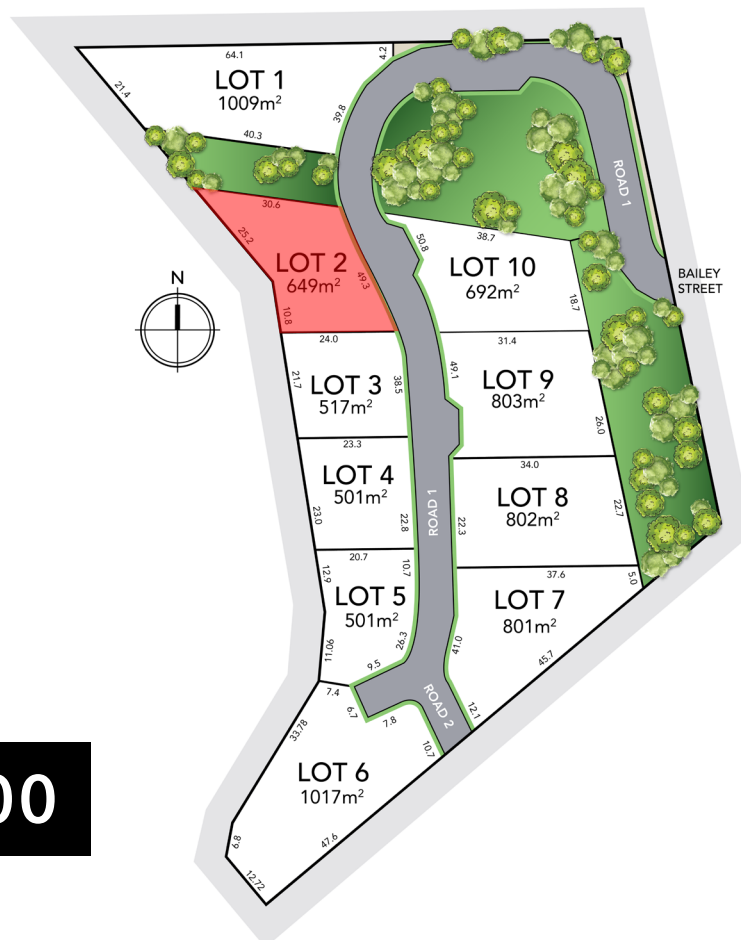
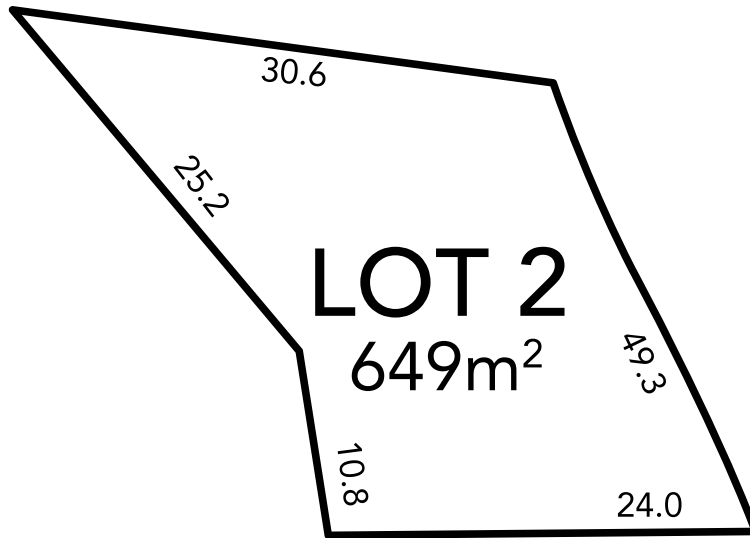

**\$250,000**

Prices are correct as of 23 September 2020 & do not include stamp duty, registration fees, or any other incidental fees associated with the acquisition of land. Scheduled completion timeframe is indicative only and subject to change without notice.

# VUE

## NAMBOUR

23 BAILEY STREET, NAMBOUR, QUEENSLAND, 4560

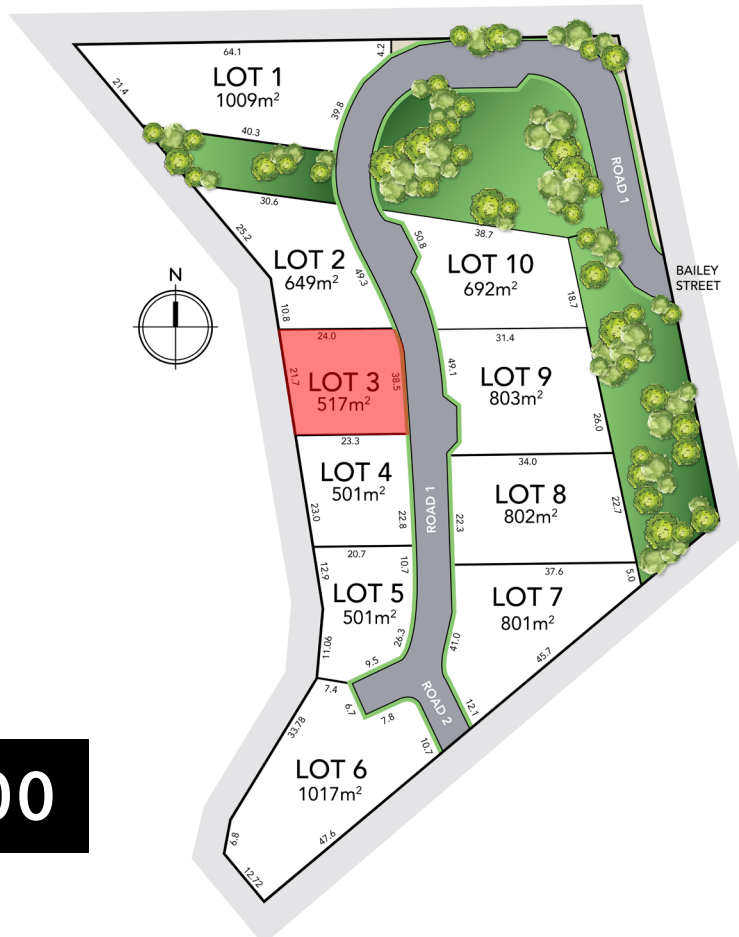
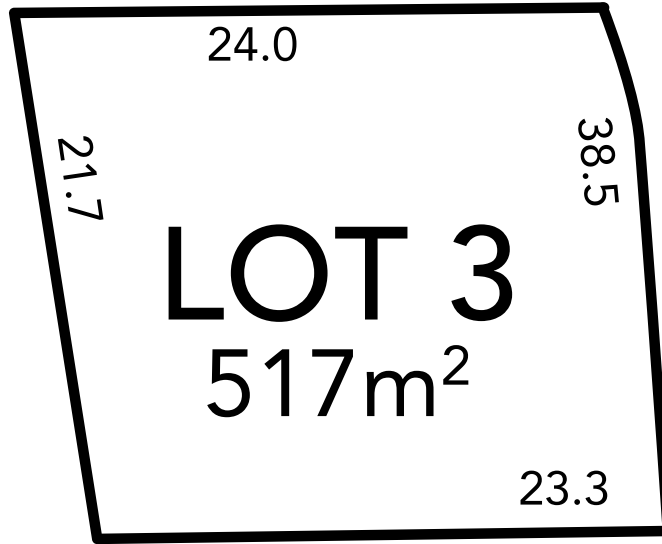

**\$250,000**

Prices are correct as of 23 September 2020 & do not include stamp duty, registration fees, or any other incidental fees associated with the acquisition of land. Scheduled completion timeframe is indicative only and subject to change without notice.

# VUE

## NAMBOUR

23 BAILEY STREET, NAMBOUR, QUEENSLAND, 4560

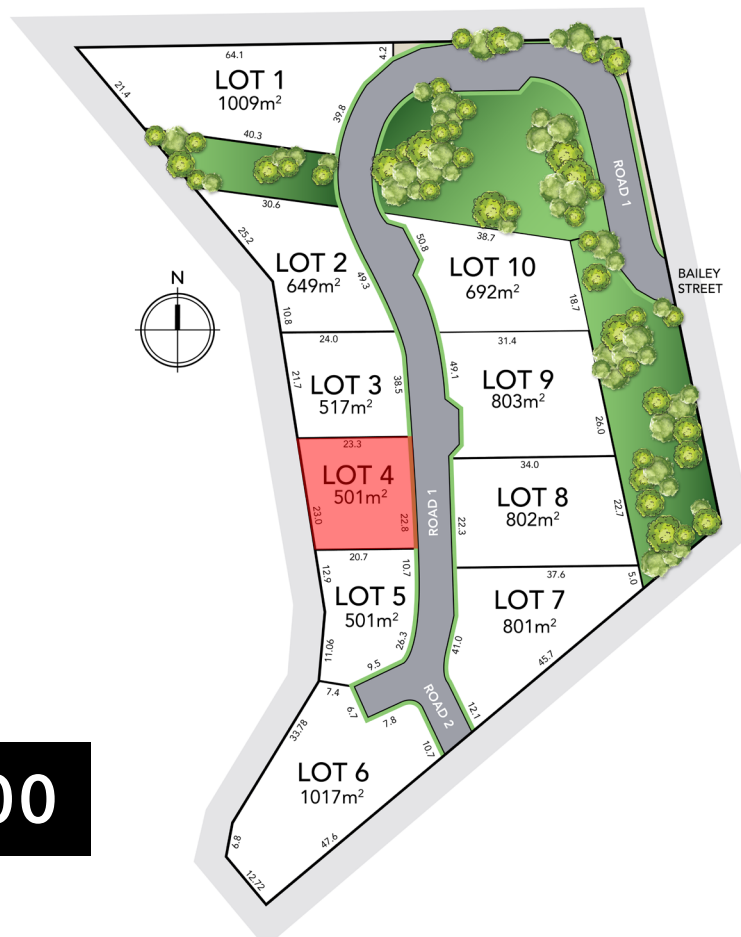
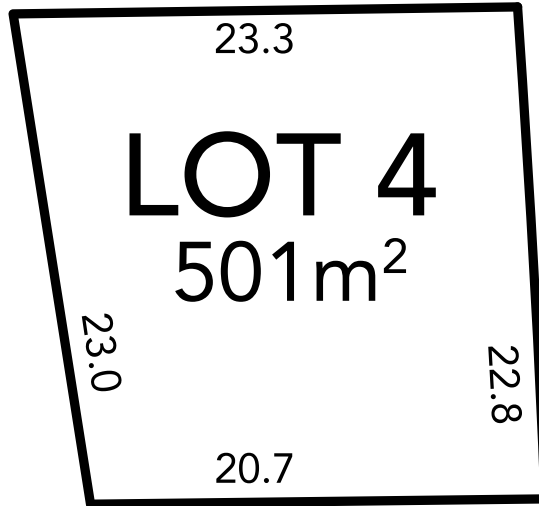

**\$250,000**

Prices are correct as of 23 September 2020 & do not include stamp duty, registration fees, or any other incidental fees associated with the acquisition of land. Scheduled completion timeframe is indicative only and subject to change without notice.

# VUE

## NAMBOUR

23 BAILEY STREET, NAMBOUR, QUEENSLAND, 4560

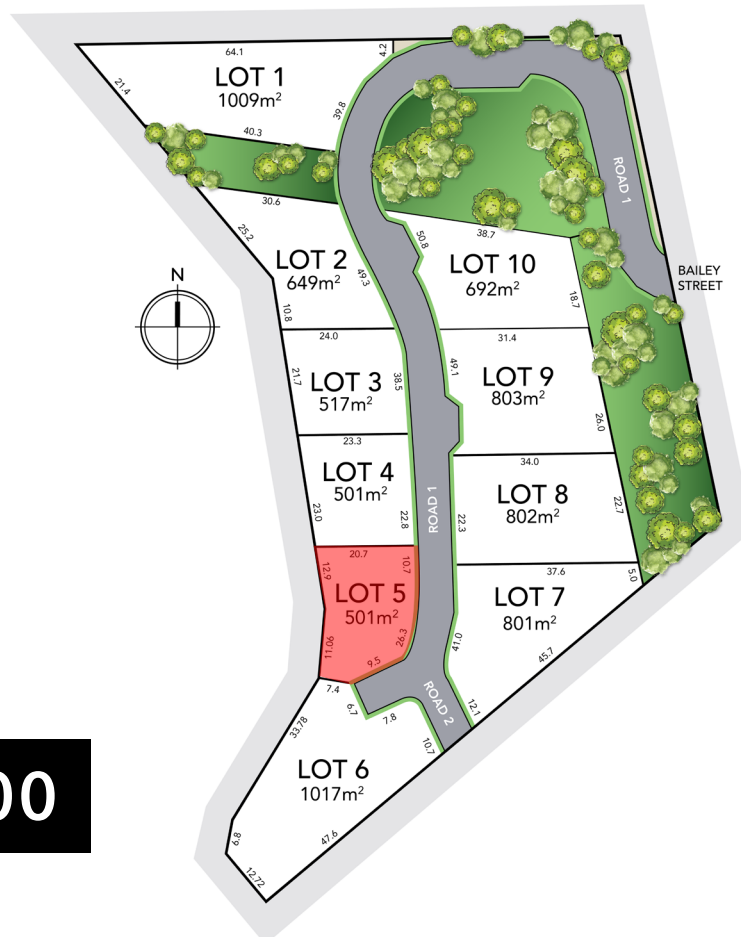
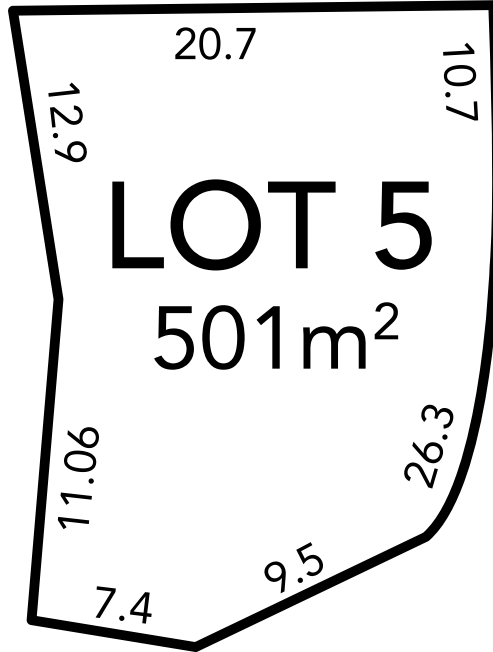

**\$250,000**

Prices are correct as of 23 September 2020 & do not include stamp duty, registration fees, or any other incidental fees associated with the acquisition of land. Scheduled completion timeframe is indicative only and subject to change without notice.

# VUE

## NAMBOUR

23 BAILEY STREET, NAMBOUR, QUEENSLAND, 4560

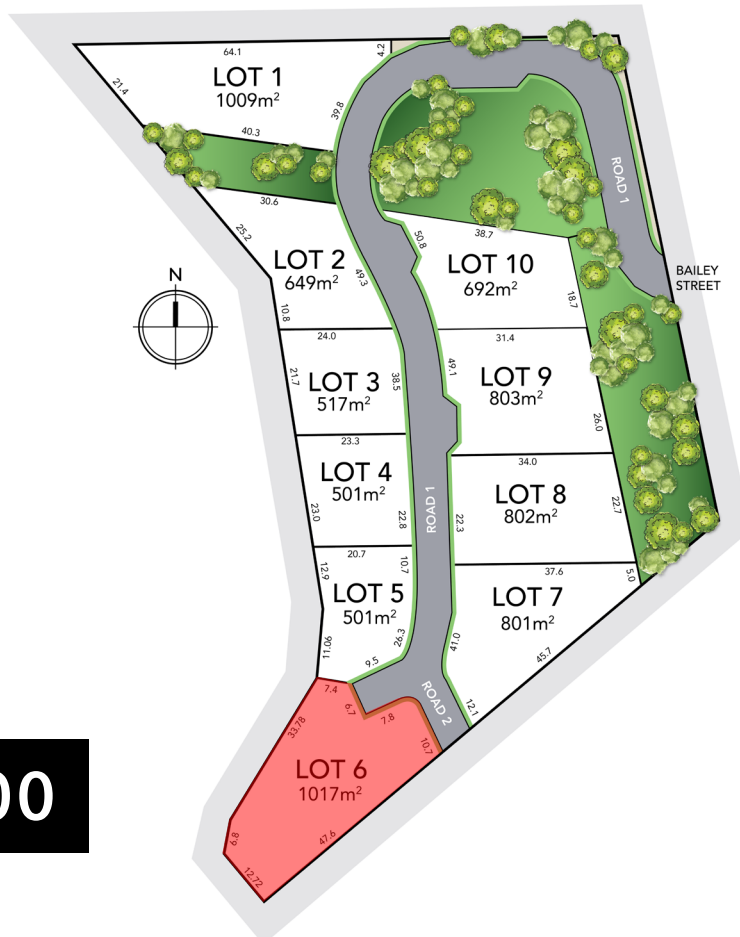
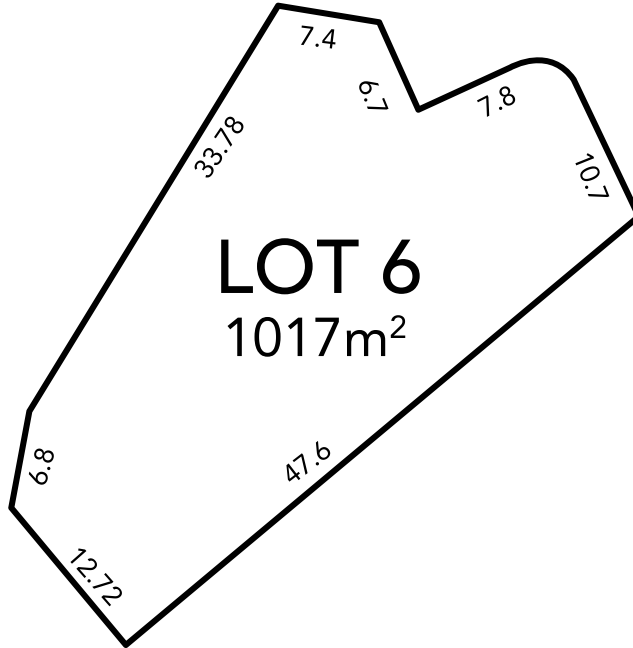

**\$300,000**

Prices are correct as of 23 September 2020 & do not include stamp duty, registration fees, or any other incidental fees associated with the acquisition of land. Scheduled completion timeframe is indicative only and subject to change without notice.

# VUE

## NAMBOUR

23 BAILEY STREET, NAMBOUR, QUEENSLAND, 4560

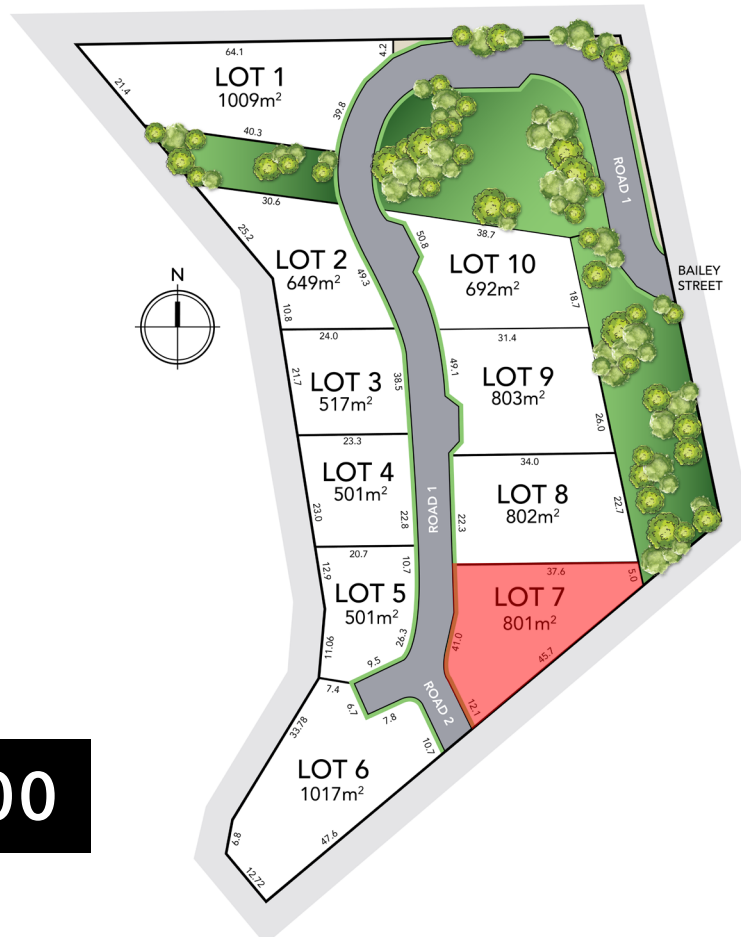
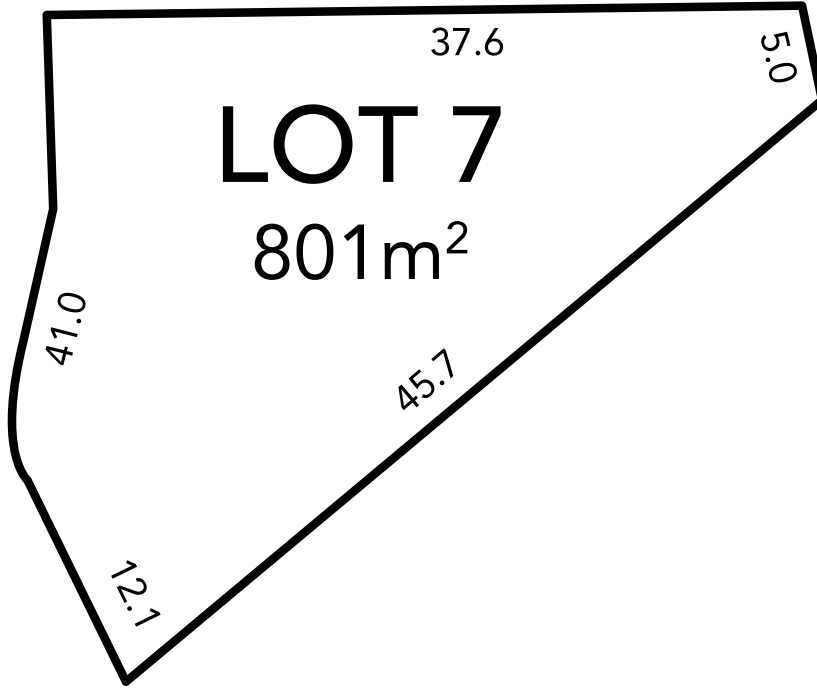

**\$300,000**

Prices are correct as of 23 September 2020 & do not include stamp duty, registration fees, or any other incidental fees associated with the acquisition of land. Scheduled completion timeframe is indicative only and subject to change without notice.





# VUE

## NAMBOUR

23 BAILEY STREET, NAMBOUR, QUEENSLAND, 4560

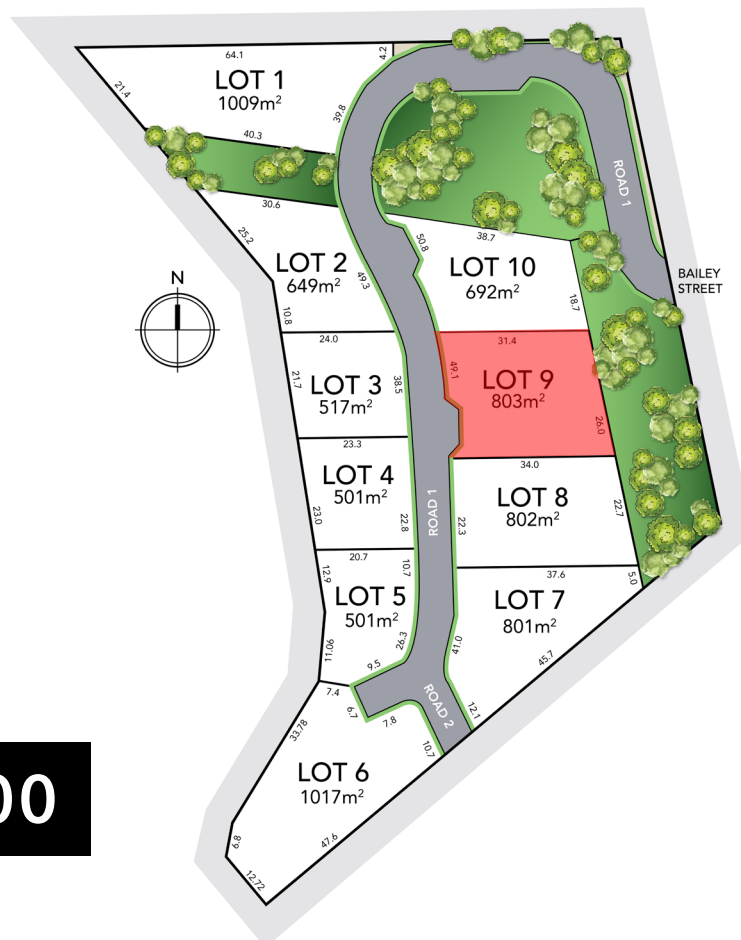
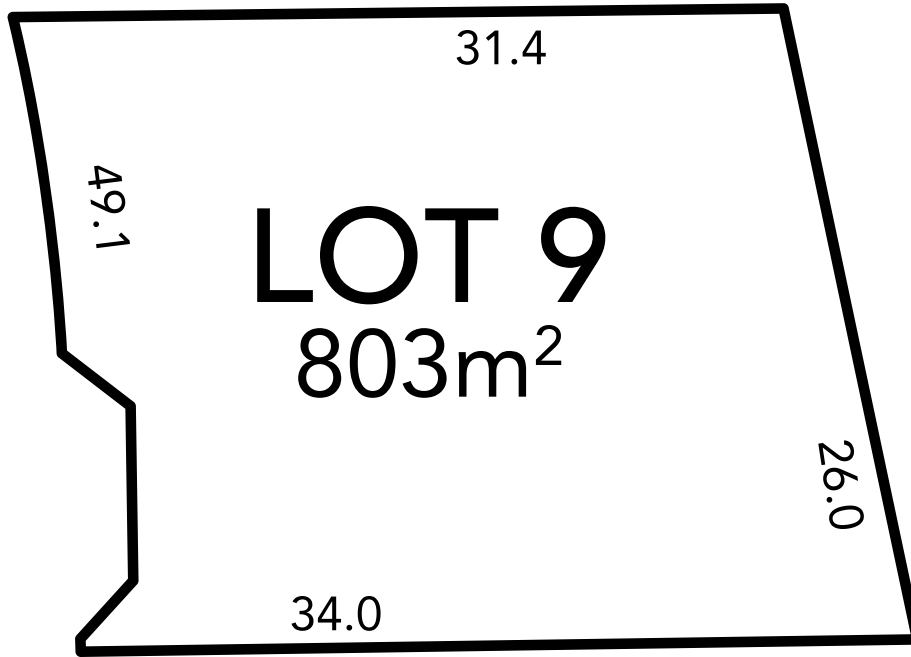

**\$300,000**

Prices are correct as of 23 September 2020 & do not include stamp duty, registration fees, or any other incidental fees associated with the acquisition of land. Scheduled completion timeframe is indicative only and subject to change without notice.

# VUE

## NAMBOUR

23 BAILEY STREET, NAMBOUR, QUEENSLAND, 4560

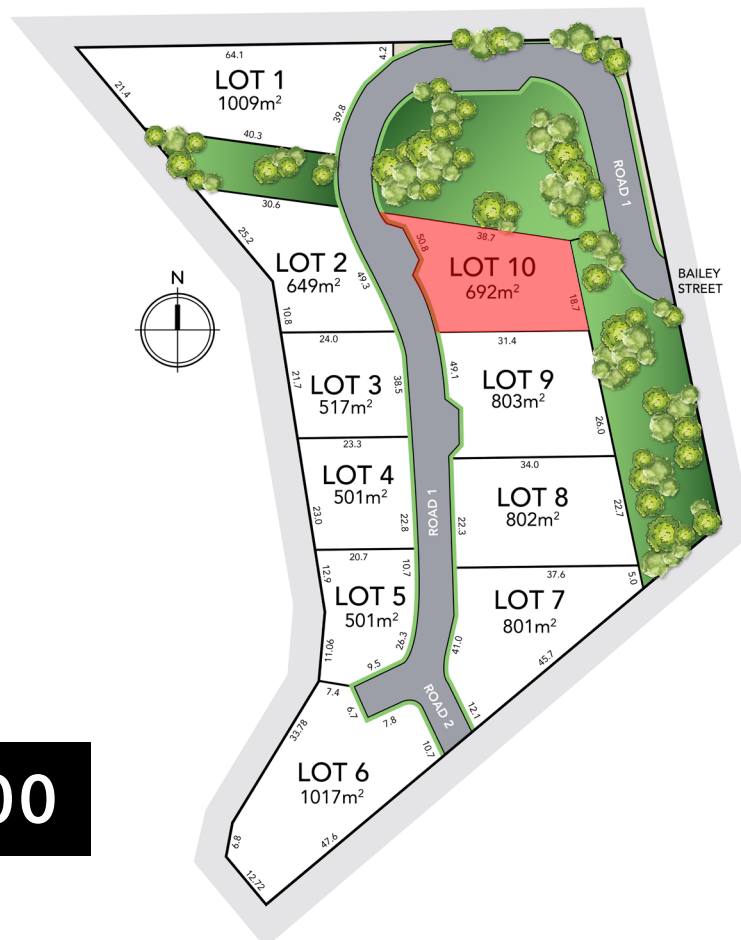
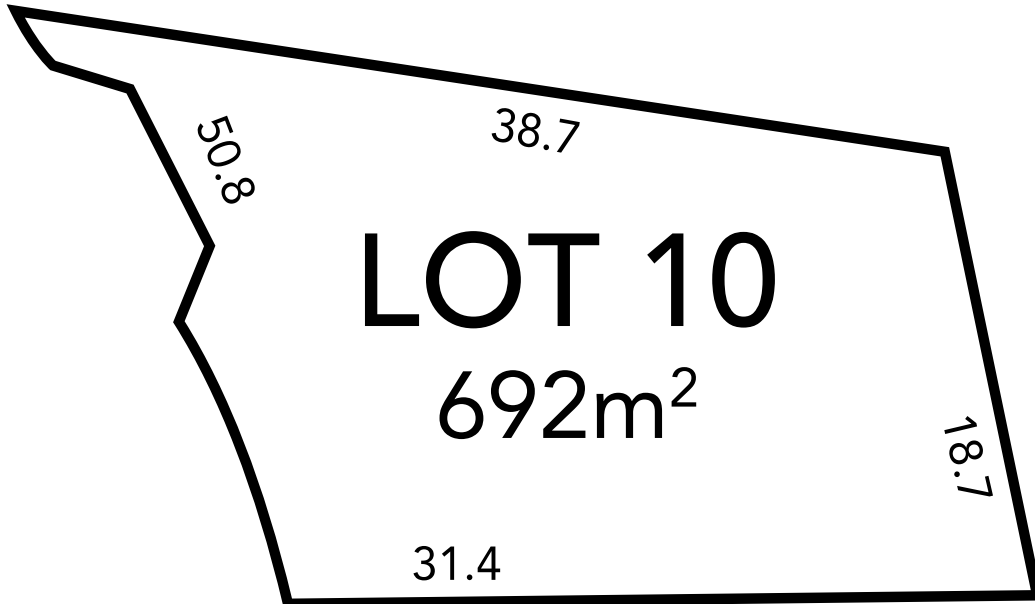

**\$250,000**

Prices are correct as of 23 September 2020 & do not include stamp duty, registration fees, or any other incidental fees associated with the acquisition of land. Scheduled completion timeframe is indicative only and subject to change without notice.